



The Honourable Marie Tehan, MP

Minister for Conservation & Land Management

240 Victoria Parade.
PO Box 41, East Melbourne, Victoria 3002, Australia
Telephone: 03 9412 4004 Facsimile: 03 9417 6225

The Hon M T Tehan MP
Minister for Conservation and Land Management
Level 17, 8 Nicholson Street
EAST MELBOURNE 3002

27 JUN '97
E 7 JUN 1997

Dear Minister

IMPLEMENTATION OF LAND CONSERVATION COUNCIL RECOMMENDATIONS - MELBOURNE AREA DISTRICT 2 REVIEW

I refer to previous correspondence of 26 October 1995 in which my predecessor gave notice of the intention to recommend to the Governor in Council that government departments and public authorities give effect to the Land Conservation Council's recommendations for the Melbourne Area District 2 Review.

I now enclose a copy of the Notice of Recommendation approved by the Governor in Council on 17 June 1997 for the recommendations set out in the attachments to the Order. Amendments advised by the Land Conservation Council are included in Attachment 3, and variations decided by the Government are specified in Attachment 4.

It would be appreciated if you could bring these approved recommendations and variations, as set out in the attachments, to the attention of the departments and authorities within your portfolio for implementation, as appropriate.

Several other recommendations - A1, A2, A4, A7(x), A12, E1(vi), E9, I7 to I10, and part O1 - were previously approved by Order in Council dated 5 September 1995. A copy of that Order is also attached for your information.

Yours sincerely

Hon Marie Tehan, MP
MINISTER FOR CONSERVATION
and LAND MANAGEMENT

MC06390



DNRE - HEAD OFFICE



D0002485

LCC T
app Actm

Original on file 2/5/4-2 #64

LAND CONSERVATION COUNCIL

Olderfleet Buildings, First Floor, 477 Collins Street, Melbourne 3000

Phone: (03) 9628 5142 Fax No.: (03) 9628 5080

Our Reference:

Your Reference:

LAND CONSERVATION ACT 1970

IMPLEMENTATION OF THE LAND CONSERVATION COUNCIL'S FINAL RECOMMENDATIONS FOR THE MELBOURNE AREA, DISTRICT 2 REVIEW

It is recommended to His Excellency the Governor in Council, that in accordance with Section 10 (3) of the *Land Conservation Act 1970*, the attached draft Order implementing the Land Conservation Council's Final Recommendations for the Melbourne Area, District 2 Review, be approved.

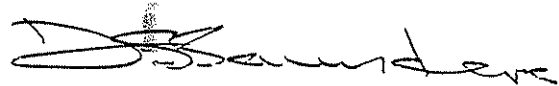

D.S. SAUNDERS
Chairman

Office of the Land Conservation Council, Melbourne

Recommended for the approval of the Governor in Council.



Hon. Marie Tehan MP
MINISTER FOR CONSERVATION
and LAND MANAGEMENT

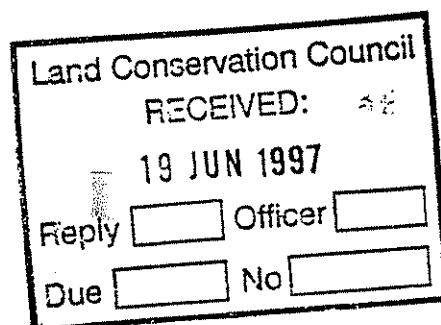
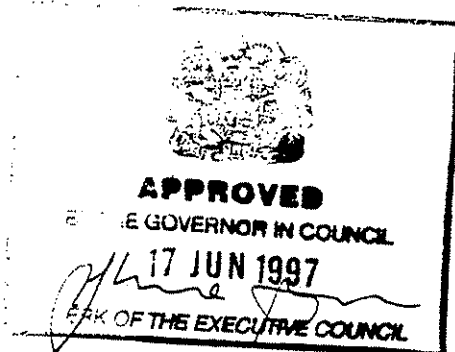

EXPLANATORY MEMORANDUM

LAND CONSERVATION ACT 1970 MELBOURNE AREA, DISTRICT 2 REVIEW FINAL RECOMMENDATIONS NOTICE OF RECOMMENDATIONS

1. Background.

The Land Conservation Council has carried out an investigation and made recommendations for the use of public land in Melbourne Area, District 2 in order to provide for the balanced use of land in Victoria.

The results of the investigation and the proposed recommendations have been published. The documents were forwarded to government departments, public authorities and municipalities, as well as made generally available, for comment.

The final recommendations have been published and tabled in Parliament. Notices of intention to implement certain of the final recommendations have been forwarded to the relevant Ministers responsible for Government departments and public authorities who may be affected.

2. Statutory Power.

The attached Order is made under sections 5(1)(a) and 10 (3) of the *Land Conservation Act 1970* which provide for the Land Conservation Council to carry out investigations and make recommendations to the Minister for Conservation and Land Management on the use of public land in Victoria.

3. The Order.

The Order in Council will direct the relevant Government departments and public authorities to give effect to these final recommendations.

Michael Crowe
Director, Land Use Planning
Land Conservation Council 9628-5124

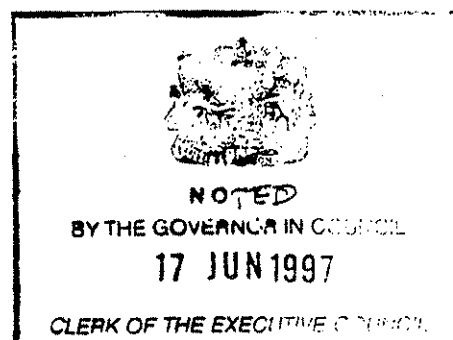

LAND CONSERVATION ACT 1970

**MELBOURNE AREA, DISTRICT 2 REVIEW
NOTICE OF RECOMMENDATIONS**

His Excellency the Governor in Council, in accordance with section 10(3) of the *Land Conservation Council Act 1970*, gives notice to the government departments and public authorities listed in Attachment 1, of the recommendations made by the Land Conservation Council under Section 5(1)(a) of the Act as listed in Attachment 2 and amendments listed in Attachment 3

and it is now the duty of those government departments and public authorities to give effect to the recommendations.

Dated:

17 JUN 1987

Responsible Minister: Hon. Marie Tehan MP
MINISTER FOR CONSERVATION
and LAND MANAGEMENT

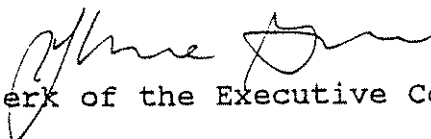
Clerk of the Executive Council

ATTACHMENT 1

- Department of Human Services
- Department of Natural Resources and Environment
- Department of State Development
- Department of Treasury and Finance
- Melbourne Water
- Parks Victoria

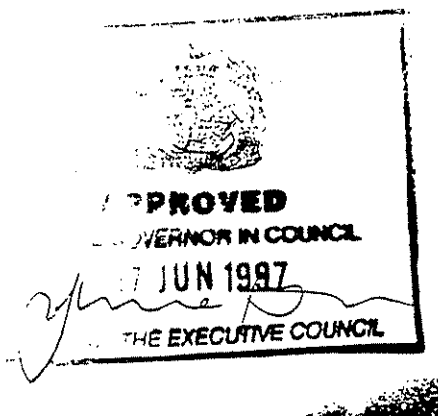

ATTACHMENT 2

MELBOURNE AREA, DISTRICT 2 REVIEW

FINAL RECOMMENDATIONS

RECOMMENDATIONS FOR IMPLEMENTATION

The following recommendations are contained in the report titled 'Melbourne Area, District 2 Review - Final Recommendations' amended in accordance with Attachment 3 (copies of which have been supplied to the Government Departments and Public Authorities listed in Attachment 1).

General Recommendations: I(a)-(f) inclusive; II-IX inclusive

Recommendations for Parks: A1--A3, A5--A11; A5; A6♣ except A6(ix) and Note 1; A7 except A7(x); A8; A9; A10♣; A11 except Note 2; A13--A27; A13; A14; A15; A16 except the Note; A18; A19; A20♣; A21; A22; A23 except A23(ix); A24; A25; A26; A28--A36; A28 to A36 inclusive

Recommendations for Reference Areas: B1--B15; B1 to B15 inclusive

Recommendations for Nature Conservation Reserves: C1; C2; C3; C4--C47; C4 to C43 inclusive; C46; C47; C48♣ except C48(iv); C49; C50

Recommendations for Water Production: D1--D13; D1 to D13 inclusive; D14--D55; D14 to D55 inclusive; D56--D60; D56 to D60 inclusive; D61

Recommendations for State Forest: E1 except E1(vi); E2 to E8 inclusive

Recommendations for Historic and Cultural Features Reserves: F1--F33, F37; F1; F2; F3; F4 except Note 4; F5; F6; F7♥; F8 to F39 inclusive

Recommendations for Natural Features Reserves: G1, G2, G5--G32, G34--G246; G1 to G4 inclusive; G5--G32; G5 to G32 inclusive; G33; G34--G41; G34 to G41 inclusive; G42--G44; G42 to G44 inclusive; G45--G246; G45 to G86 inclusive, G88 to G129 inclusive; G131 to 168 inclusive; G170 to G206 inclusive; G207♦; G208 to G235 inclusive; G237 to G246 inclusive

Recommendations for Alpine Resorts: I1 to I6 inclusive; I11

Recommendations for Community Use Areas: J1--J29; J1--J10; J1 to J9 inclusive; J11 to J14 inclusive; J15--J18; J15 to J18 inclusive; J19; J20--J27; J20 to J27 inclusive; J28; J29

Recommendations for Plantations: K1 to K8 inclusive

Recommendations for Earth Resources: L1 to L3 inclusive

VERIFIED IN COUNCIL

EXECUTIVE COUNCIL

Recommendations for Services and Utilities: M1,M3,M4,M6--M19, M21;
M1 to M8 inclusive; M9,M10; M9; M10; M11 to M16 inclusive;
M17(v),(vi); M18 to M21 inclusive

Recommendations for Uncategorised Public Land: N1; N2; N3; N5

Recommendations for Land Not Required for Public Purposes:
O1,O3,O4; O1 except the former McLeod Prison Farm site; O3;
O4

Recommendations for Defence Force and Other Training: P1 to P2
inclusive

- ♣ Except to the extent that the recommendation affects land held by Melbourne Water
- ♥ Except for Crown Allotments 21 and 21A sec 8 Parish of Taggerty
- ♦ Except for Crown Allotment 3A sec 2 Township of Noojee

MELBOURNE AREA DISTRICT 2 REVIEW

AMENDMENTS TO THE RECOMMENDATIONS ADVISED BY THE LAND CONSERVATION COUNCIL

These include minor amendments proposed in Ministers' responses.

1. Additional provisions for an existing leaseholder in the proposed addition to the Dandenong Ranges National Park

Recommendation A6 Dandenong Ranges National Park addition

Add the following clause:

(x) the existing leaseholder of the area known as Tonkin's flower farm be offered a short term lease over the northern clearing and a longer term lease over the southern clearing as shown in Map J

Include an additional sentence in note 4:

The leases referred to in A6(x) could also make provision for these dams, as well as provision for the relocation of plantings of rare species and the control of pest plants.

2. Change of name of Nepean National Park

Recommendation A10 - This park is to be named the Mornington Peninsula National Park.

3. Continued access to freehold lands surrounded by and adjoining the Cathedral Range State Park additions

Recommendation A14 - add note:

Note: Access should continue to be available to private land surrounded by and adjacent to the park addition.

4. Addition to the Warrandyte--Kinglake nature conservation link.

Recommendation C48 - add two adjoining Melbourne Water-owned allotments, CA 35 and part CA 43 sec B Parish of Queenstown, covering the area of 13.2 ha shown on Map K attached, to the C48 Warrandyte--Kinglake nature conservation link.

These blocks were brought to Council's attention by the then Shire of Eltham and Melbourne Water subsequently confirmed that they had been omitted from their tenure map. They both contain remnant vegetation and form a logical and integral part of the recommended link.

5. Addition of new nature conservation reserve at Cape Paterson

Council is now aware of a previously unclassified block of public land at Cape Paterson - CA 11A sec F Parish of Wonthaggi. The allotment contains remnant heathland which is notably rich in orchids (over 40 species).



APPROVED

GOVERNOR IN COUNCIL

17 JUNE 1997

THE EXECUTIVE COUNCIL

orchids occurring are of State significance, including two undescribed species. The Department of Natural Resources and Environment and the former Borough of Wonthaggi have been working together to protect the biological values of this area. It is proposed that this area, as shown on Map L attached, become a nature conservation reserve to be managed in accordance with Recommendation C4--C47 by the Department of Natural Resources and Environment.

6. Addition of note to Water Production Areas

Recommendations D14--D55 - add note:

3. Areas D15 - D19 are within Kinglake National Park, and Areas D28 - D32, D36 and D41 are within Yarra Ranges National Park.

7. Recognition of an additional State forest value

Recommendation E7 - add the following value to Table 16 Special Features to be Protected in State Forest, under the nature conservation section of the Tarago--Latrobe, Neerim, and Tanjil--Tyers forests:

** the vulnerable tall astelia (Astelia australiana) within the upper Latrobe River catchment (Council is aware that a moratorium has been placed on timber harvesting in some areas to protect this species - see Chapter C)*

8. Deletion of a modified natural features reserve

Recommendation G169 - delete from Table 19 Bushland Areas. This 0.4 ha block, CA 22A Parish of Monbulk, was incorrectly identified as having bushland values. It is now to be included within the uncategorised public land category (N1).

9. Deletion of a modified portion of a natural features reserve

Recommendation G207 - delete part of the area comprising CA 3A sec 2 Township of Noojee from the description in Table 19 Bushland Areas. The Department of Natural Resources and Environment has requested that this small allotment, which is a small cleared area on the edge of the recommended reserve, be made available for sale.

10. Correction of descriptions of Natural Features Reserves

Recommendation G237 - amend description to read: part CA 48 sec 54A, part CA 7 sec 3C and adjoining sections of unused road, Township of Wonthaggi

Recommendation G240 - amend description to read: CAs 4L, 46 to 49 sec 117, CA 1 sec 102 Township of Wonthaggi

Recommendation G242 - amend description to read: CAs 3, 4, 5 sec 110, CAs 15, 16 sec 111, part CA 22 sec 112, part CAs 6, 7 sec 110 Township of Wonthaggi

Recommendation G245 - amend description to read: CA 8 sec 86 and adjoining road reserve, Township of Wonthaggi

11. Deletions to reflect changed land tenure

Delete the following recommendations as they are no longer Crown land. These have been sold since the publication of the Council's Final Recommendations.

Recommendation G130, CA 38B Parish of Kinglake - delete from Table 19 - Bushland Areas. This is a former Police Reserve with remnant vegetation.

Recommendation J13 - delete CA 2A sec 4 Township of Wonthaggi (the Wonthaggi Bowling Club) from the recreation areas listed in Appendix VII.

Recommendation J13 - delete CA 90A Parish of Lang Lang (the Lang Lang Golf Course) from the recreation areas listed in Appendix VII.

12. Correction of typographical errors

Recommendation J13 - the reference to Appendix VIII (p234) should read Appendix VII

Recommendation J14 - the reference to Appendix VII (p234) should read Appendix VI.

13. Clarification of boundary of possible future Hastings port land on the Tyabb foreshore

Recommendation M6 - in the first sentence of Note 1 replace 'The Bluff' with 'Iluka Road'.

14. Recommendation N1 - Uncategorised public land

Delete parts CAs 11E and 13C sec C Parish of Tanjil East from Appendix IX.

Minor corrections to Appendix IX are required to delete 11 areas (added to adjoining reserves or duplicates of other recommendations). A listing of these areas has been forwarded to NRE.

15. Correction of recommendation wording

Recommendation N2 - the reference to 'land not required for public purposes' (p269) should read 'uncategorised public land'.

16. Clarification of disused railways recommendation

Recommendation N5 - add note:

Note: This recommendation does not apply to those disused railways or those sections of disused railways for which Council has made a specific recommendation.

17. Correction of areas recommended as not required for public purposes

Recommendation O1 - transfer the existing Korumburra Police Station, CA 1A sec 4 Township of Korumburra, from Table 24 Land Not Required for Public Purposes to Appendix VIII Services and Utilities (recommendation M15). Note that this changed recommendation would not preclude the sale of the facility in the future should this be required.

Recommendation O1 land exchanges (p276) - delete reference to CA 1, part CAs 3B and 8A sec 3 Parish of Kangerong and add these allotments to Appendix IX - Uncategorised Public Land (recommendation N1) with the following note added: *May be suitable for land exchange to consolidate the boundaries of Arthurs Seat State Park.*

18. Adjustment to Olinda Creek Frontage

Recommendation O2(ii) - amend to read:
'land within 20 m of the north bank of Olinda Creek be retained ...'

(refer to recommendation A6 and Map J)

NOTE:

Amendment 1. above regarding Silvan No.2 land in the proposed addition to the Dandenong Ranges National Park, **Amendment 4.** regarding an addition to the Warrandyte--Kinglake nature conservation link, and **Amendment 18.** regarding an adjustment to Olinda Creek frontage, all relate to land held by Melbourne Water. As indicated on the Order and listed on p.6 of Attachment 4, those recommendations are not to be approved at this stage.

MAP J

CLEARING AREAS TO BE OFFERED
FOR LEASE TO EXISTING
LEASEHOLDER IN RECOMMENDED
ADDITION TO THE DANDENONG
RANGES NATIONAL PARK

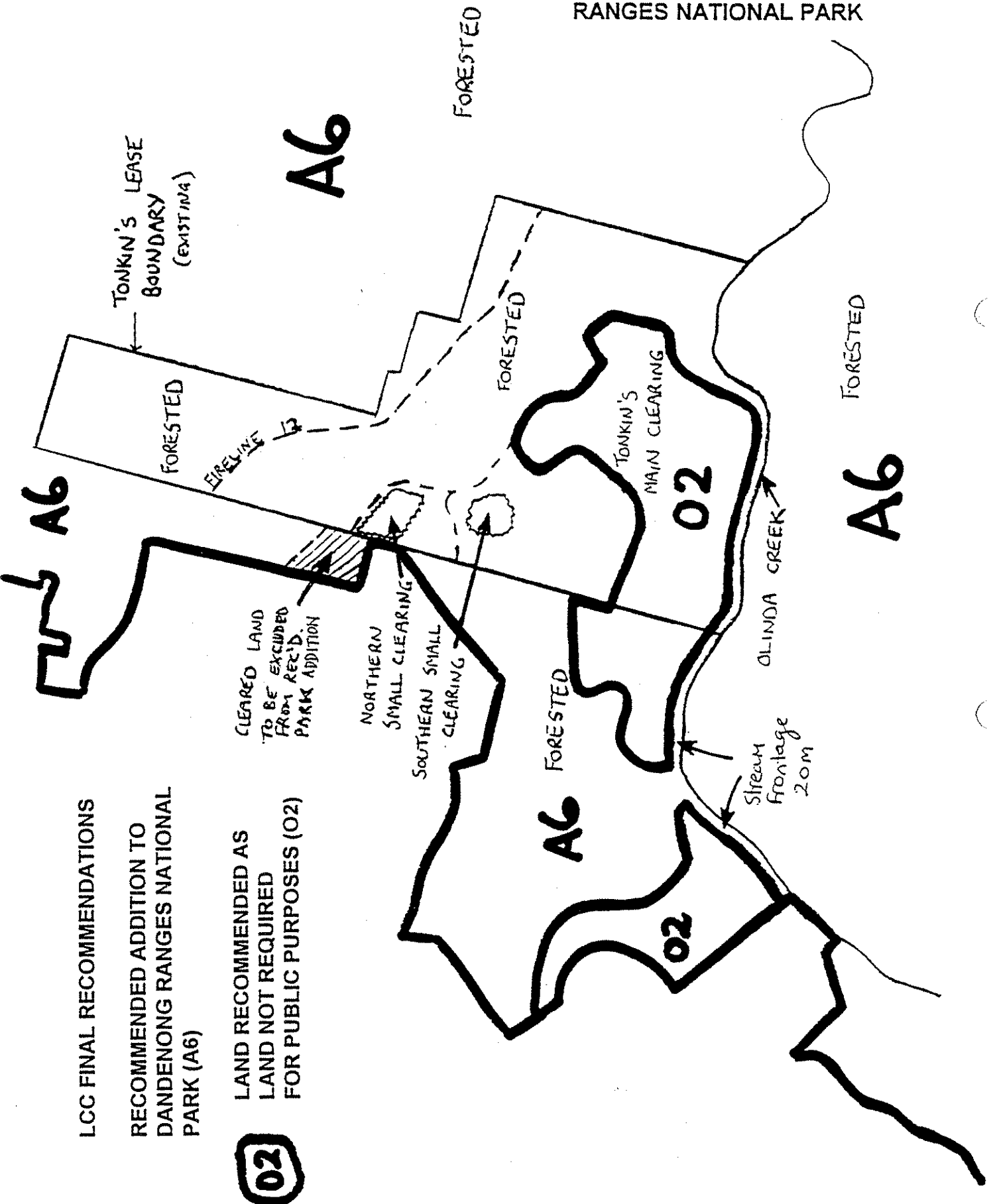

LCC FINAL RECOMMENDATIONS

RECOMMENDED ADDITION TO
DANDENONG RANGES NATIONAL
PARK (A6)

LAND RECOMMENDED AS
LAND NOT REQUIRED
FOR PUBLIC PURPOSES (02)

02

MAP K

ADDITION TO THE WARRANDYTE-KINGLAKE NATURE CONSERVATION LINK

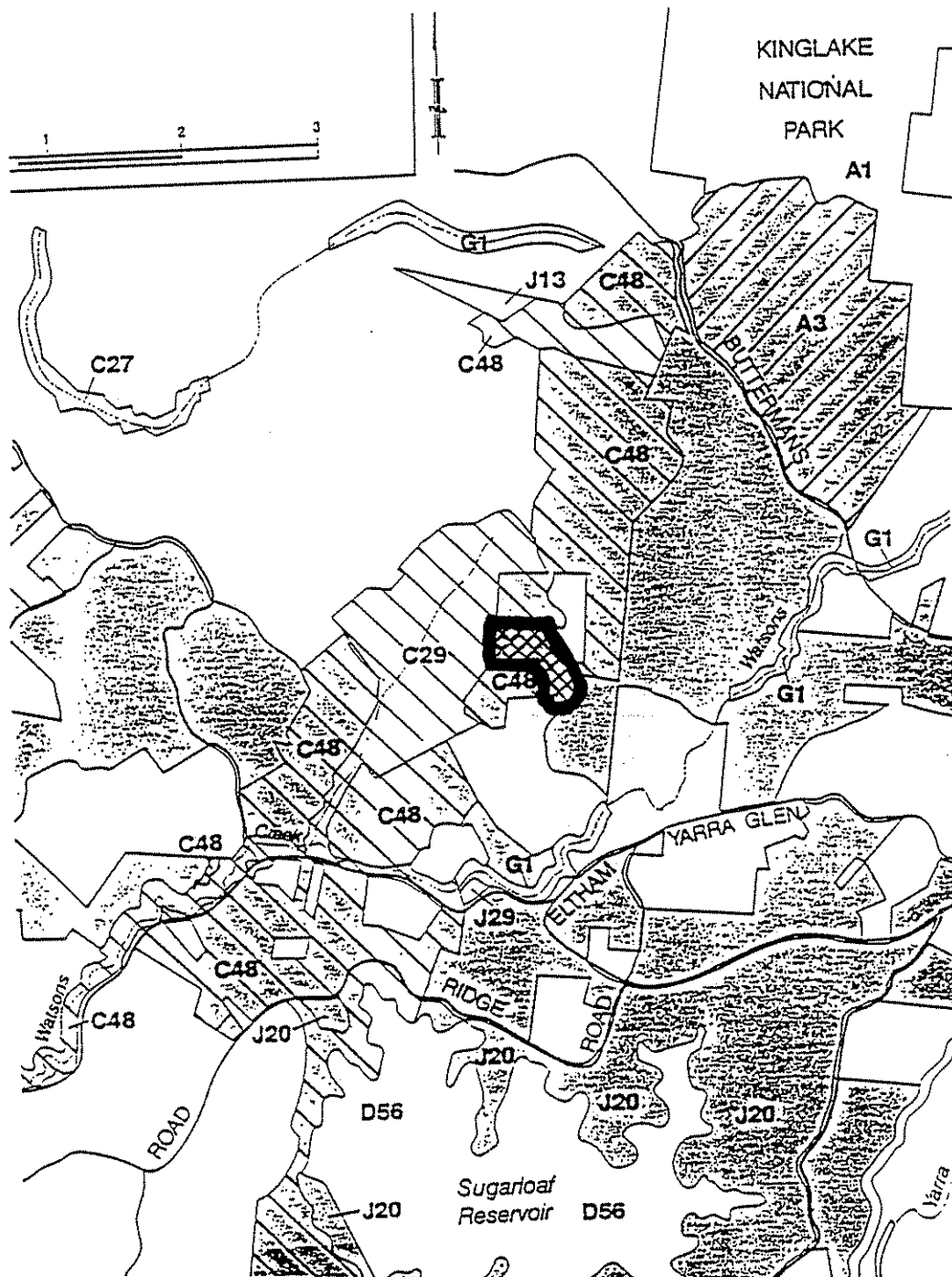

ADDITION TO WARRANDYTE - KINGLAKE
NATURE CONSERVATION LINK (C48)

MAP L

RECOMMENDED NATURE
CONSERVATION RESERVE AT
CAPE PATERSON

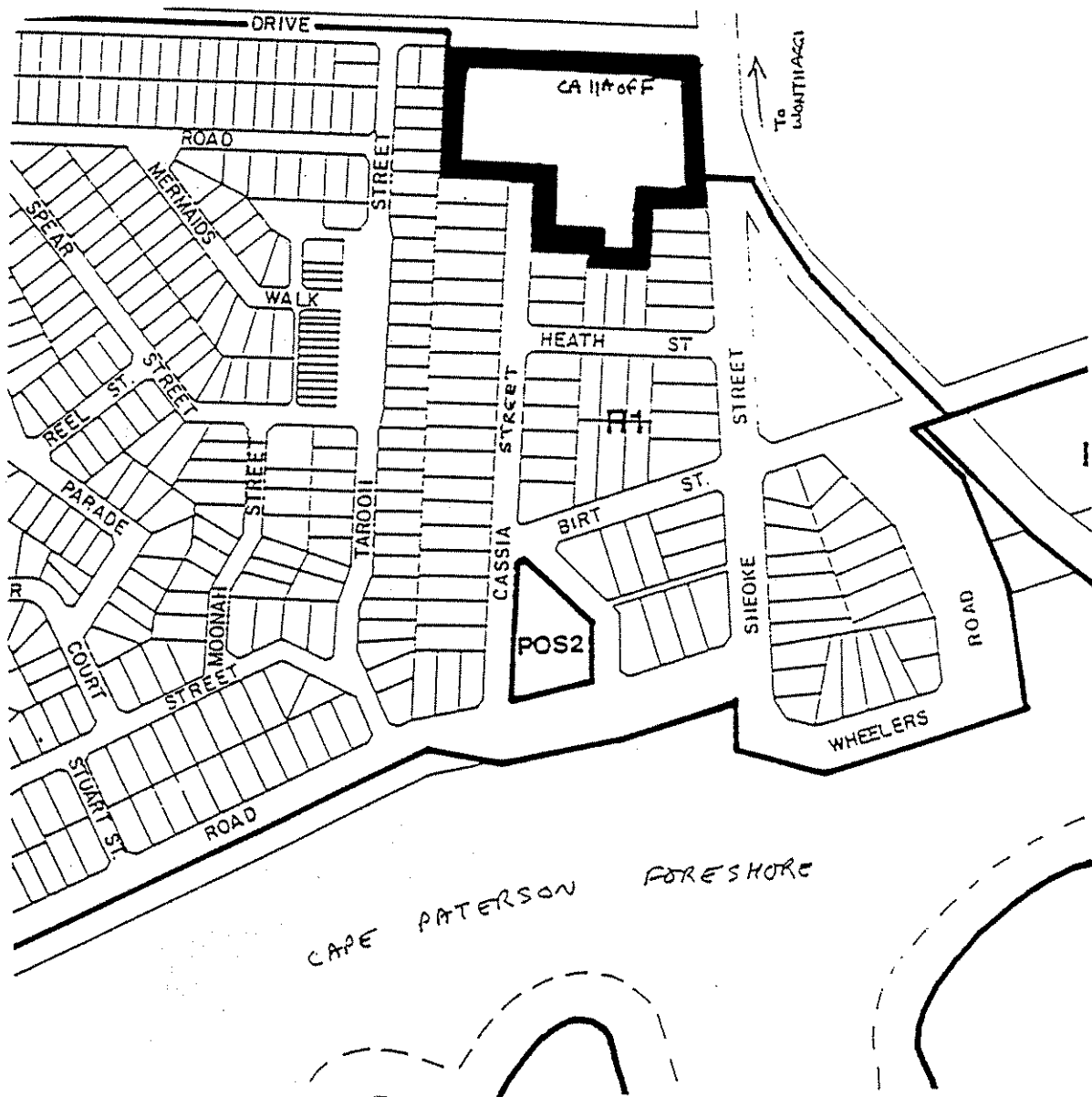

ADDITIONAL NATURE CONSERVATION RESERVE

MELBOURNE AREA, DISTRICT 2 REVIEW RECOMMENDATIONS

GOVERNMENT VARIATIONS

Variation 1 - Recommendation A6: changes to the additions to Dandenong Ranges National Park

Recommendation A6(ix) - replace by the following:

(ix) the Mount Dandenong Arboretum be included as a special management zone within the park.

Delete Note 1 regarding the 'Skyhigh' restaurant area.

Exclude the following areas from the park additions:

Area on western side of R J Hamer Arboretum (to be added to J19 parklands and gardens; see Map M)

Area between Chalet Road and Olinda--Monbulk Road (to be a new natural features reserve - bushland area; see Map M)

Mount Dandenong Observatory Reserve (to be a J29 community use area)

Kallista Works Depot complex (to be O1 land not required for public purposes)

Variation 2 - Recommendation A11: addition to French Island National Park

Add the following area to the park:

Parts CAs 13, 14B Parish of French Island (63 ha).

Replace Note 2 by the following:

Excluded from the park are the cemetery, refuse tip, Tankerton jetty and barge landing sites and an area around the former McLeod Prison. Tankerton jetty and the site near Red Bluff are excluded to permit the establishment of a Committee of Management to manage and serve them.

Variation 3 - Recommendation A12: acknowledgement of existing water use and school camp in Yarra Ranges National Park

Add new recommendation:

(xv) harvesting at 1994/95 or similar levels of water from the Taggerty River by the Lake Mountain Alpine Resort managers and the continued existence of a water storage tank north of Gerratys be permitted, with any change to storage of increase

BY THE GOVERNOR IN COUNCIL
17 JUN 1997
CLERK OF THE EXECUTIVE COUNCIL

in harvesting to be subject to the consent of the Director of National Parks or, if major, subject to referral to the Minister responsible for the Environment Effects Act 1978 for consideration under that Act.

Add notes:

Note 5: Council is aware that a small school camp (known as Camp Duncan) is within the park boundaries; this use may continue at the park managers' discretion.

Note 6: A television transmission facility on Mt Victoria may continue in use at the land manager's discretion.

Variation 4 - Recommendations A15, A16, A17: change of name and status for Eildon - Fraser State Park, and qualification of park addition

This park including the recommended additions is to be named Lake Eildon National Park.

Delete note to Recommendation A16.

Recommendation A17 Mt Pinninger addition - replace by the following:

That the area of about 165 ha be added to the Lake Eildon National Park, subject to its being acquired from the Goulburn-Murray Rural Water Authority, and be used according to the general recommendations for national parks.

Variation 5 - Recommendation A22: addition to Bunyip State Park

Add the following area, as shown on Map N, to the park:

CA 70A Parish of Bunyip (about 38 ha).

Variation 6 - Recommendation A23 Moondarra State Park: change of management arrangements for part

Replace Recommendation A23(ix) by the following:

the land in the Anderson Creek Headwaters, which is currently on the Schedule to the National Parks Act 1975 but not yet proclaimed as part of the park, be managed under a Section 19C agreement pending resolution of the possible future requirement for this land as part of an overburden dump site associated with open-cut coal-mining.

Variation 7 - Recommendation A27 Phillip Island State Park: change of name, status, management arrangements and boundaries

Replace Recommendation A27 by the following:

Phillip Island Nature Park

That the area of about 2400 ha indicated on Map A together with the Ventnor Koala Reserve (previously C44), the Koala Conservation Centre (prev. C45) and Newhaven Swamp (prev. G236) of 137 ha be used in accordance with the general recommendations for State parks set out in A13--A27(i) - (viii), and with A27 (ix), (x), (xi) and (xiii)

that

- (a) manipulation of natural systems be permitted at the Koala Conservation Centre to ensure the protection and enhancement of koala habitat and food sources;
- (b) the land managers restore the natural water levels of Newhaven Swamp;

and that

- (c) the area be reserved under the Crown Land Reserves Act 1978 and be managed by a committee of management established under that Act and chaired by the Director of National Parks.

Include Notes 2, 4, 5 and 6 as in Recommendation A27

Replace Note 3 by the following:

A draft 'Wildlife Strategy Plan for Phillip Island' included assessment of the potential of the Island's faunal values to facilitate opportunities for tourism. It also proposed that facilities be developed to enable the public to view penguins (now completed), koalas (now completed - at the Koala Conservation Centre), short-tailed shearwater rookeries (possibly at Forrest Caves or Cape Woolamai) and the intertidal flats (possibly at Rhyll Inlet).

Variation 8 - Recommendation A33 Addition to Crossover Park: change to boundaries

Exclude the following area from the recommended park addition:

About 1.9 ha on Gunn Road in the former Township of Crossover shown on Map O attached and containing an operating sawmill (to be 01 land not required for public purposes)

Variation 9 - Nature Conservation Reserves (now parts of A27 Phillip Island Nature Park - consequences of variation 7)

Delete the following recommendations:

- C44 Ventnor Koala Reserve
- C45 Koala Conservation Centre

Variation 10 - Recommendation F4 Emerald (Puffing Billy) Railway: provision for existing use

Replace Note 4 by the following:

Part of the Gembrook station ground area is occupied by a Country Fire Authority station. This occupation should be permitted to continue or alternative siting arranged.

Variation 11 - Recommendation F7 Rubicon Historic and Cultural Features Reserve: change to boundary

Exclude CAs 21 and 21A sec 8 Parish of Taggerty (not to be approved at this stage).

Variation 12 - Recommendations G45--G246 natural features reserves: deletion and additional reserves

Delete the following recommendation:

- G236 Newhaven Swamp (now part of A27 Phillip Island Nature Park - consequence of variation 7)

Add the following areas:

Beveridge Bushland Area

Parts CAs 61, 62 Township of Beveridge; approximately 3.4 ha (see Map P)

Note: The spring-fed wetland and associated flora and fauna are to be protected.

Murrindindi Bushland Area

CA 4D sec C Parish of Woodbourne; approximately 10 ha (see Map Q)

Note: The weed-free remnant native vegetation and old trees need protection.

Olinda Bushland Area (consequence of variation 1)

Area between Olinda--Monbulk and Chalet Roads; approximately 7ha; to be temporarily reserved (see Map M)

Variation 13 - Additional community use areas (consequences of variation 1)

Add the following areas:

Mount Dandenong Observatory Reserve (previously part of A6 Addition to Dandenong Ranges National Park) to J29 tourist facilities in public use

The area on the western side of RJ Hamer Arboretum (previously part of A6 Addition to Dandenong Ranges National Park) to J19 parklands and gardens (see Map M); this area is to be managed by Parks Victoria

Note: The stands of indigenous vegetation on the western edge of the arboretum should be conserved, and pedestrian access through this section of the Arboretum, to the Olinda block of the adjoining Dandenong Ranges National Park should be maintained.

Variation 14 - Recommendation J10 Woorabinda

Replace the recommendation by the following:

That the area of 49 ha indicated on Map A be used for those purposes approved by the government following publication of the final recommendations (Recommendation H7) for the Latrobe Valley Special Investigation in October 1987.

Variation 15 - Recommendation M1,M3,M4,M6--M19,M21 services and utilities: application to roads in subdivisions

Add the following note:

Note: Recommendation M1,M3,M4,M6--M19,M21(iii) does not apply to road reserves in the following subdivisions:

Volume 6469 folio 693, pt CA 13A sec C Parish of Tanjil East
 V. 8331 f. 459, pt CA 7F sec C Parish of Tanjil East
 V. 8331 f. 460, pt CA 7G sec C Parish of Tanjil East
 V. 8331 f. 461, pt CA 18G sec A Parish of Tanjil East
 V. 8331 f. 463 (part title only), pt CA 30E sec A Parish of Tanjil East
 V. 8646 f. 277, pt CA 17 sec D Parish of Tanjil

Variation 16 - Recommendation N1 uncategorised public land: deletion (consequence of variation 12)

Delete the following area from Appendix IX:

Parts CAs 61, 62 Township of Beveridge (now a natural features reserve)

Variation 17 - Recommendation N4 Crown land assessment and classification

Replace the wording of the recommendation by the following:

That, in relation to land classified as Uncategorised Public Land, Services and Utilities and Community Use Areas (buildings in public use) that is apparently surplus to requirements, an assessment of public land values be undertaken and, following appropriate consultation, these areas be considered for recategorisation by LCC, land exchange or disposal.

Delete the note to recommendation N4.

Variation 18 - Recommendation O1 land not required for public purposes: deletion and additional areas

Delete the following Recommendation from Table 24:

Parts CAs 13, 14B Parish of French Island (now part of A11 French Island National Park - consequence of variation 2)

Add the following areas to Table 24:

Parts CAs 11E and 13C sec C Parish of Tanjil East; 120.6 ha

Part CA 28A and parts CAs 1, 2, 15 and 16 sec 8 Parish of Taggerty; 11.5 ha.

Kallista NRE Works Depot complex (consequence of variation 1)

1.9 ha on Gunn Road, Township of Crossover (consequence of variation 8)

Recommendations for certain Melbourne Water lands not to be approved at this stage

This affects recommendations

A3 Reedy Creek addition to Kinglake National Park

M17(vii) O'Shannassy Aqueduct

O2 Silvan No.2 land

and parts of the following recommendations:

A6 Dandenong Ranges National Park additions - Silvan No.2 land

A10 Mornington Peninsula National Park - Boags Rocks

A20 Warrandyte State Park additions - parts that are Melbourne Water land

C48 Warrandyte--Kinglake nature conservation link - parts that are Melbourne Water land

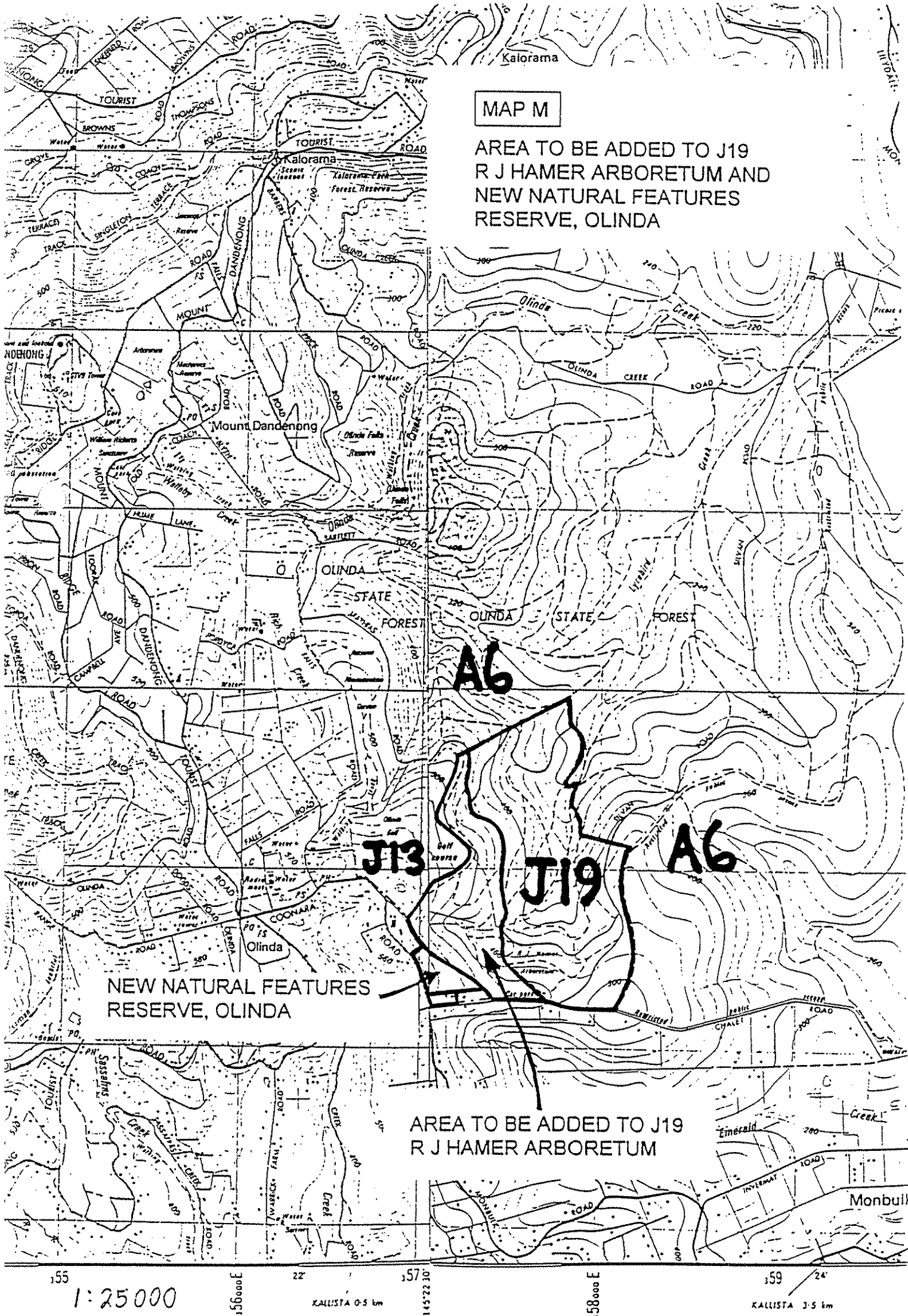

MAP N

LAND TO BE ADDED TO THE
BUNYIP STATE PARK

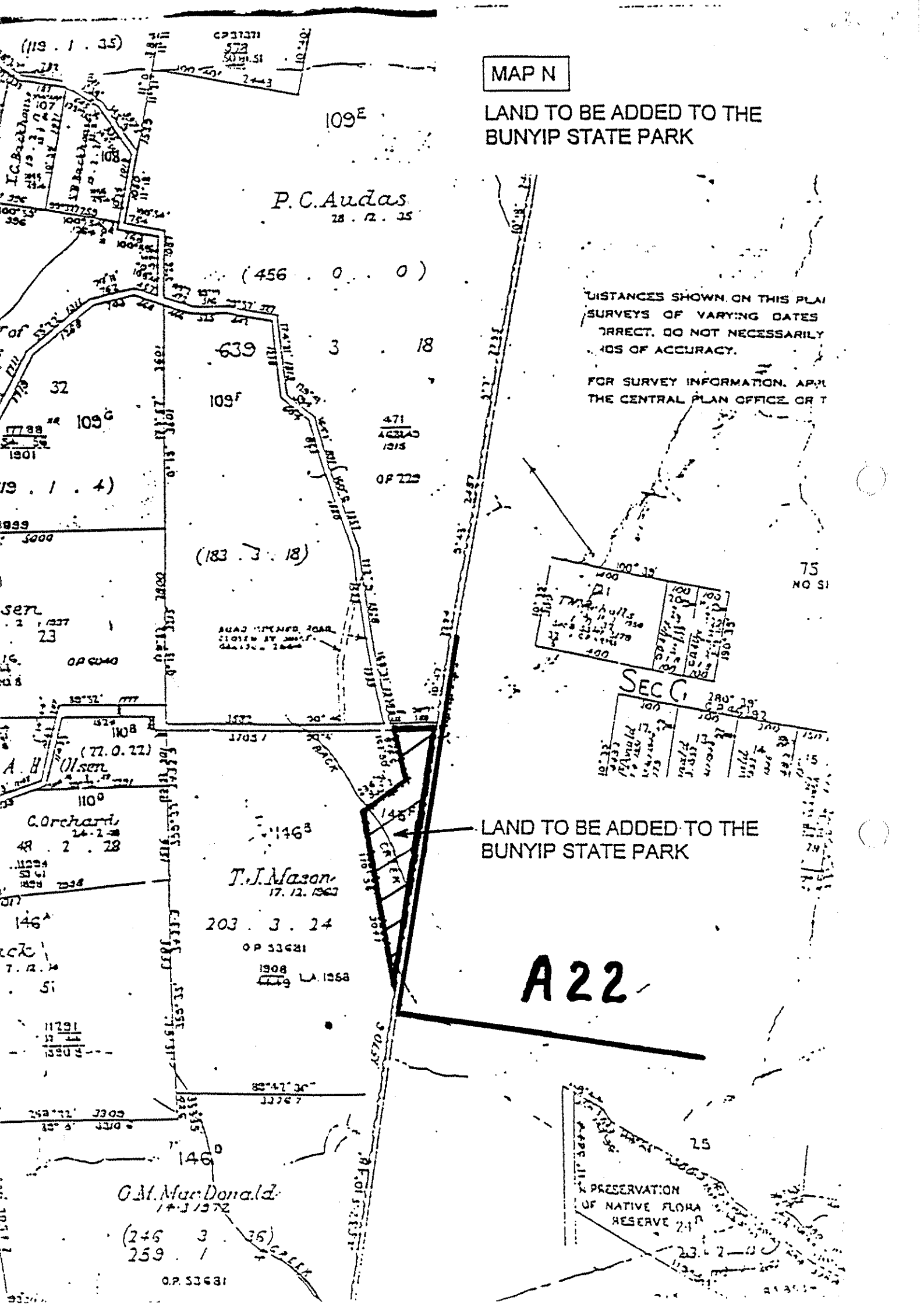

DISTANCES SHOWN ON THIS PLAN
SURVEYS OF VARYING DATES
CORRECT. DO NOT NECESSARILY
IMPLY ACCURACY.

FOR SURVEY INFORMATION, APPLY
THE CENTRAL PLAN OFFICE OR T

LAND TO BE ADDED TO THE
BUNYIP STATE PARK

A22

PRESERVATION
OF NATIVE FLORA
RESERVE 21

PROPOSED EXCLUSION FROM A33 CROSSOVER REGIONAL PARK ADDITION

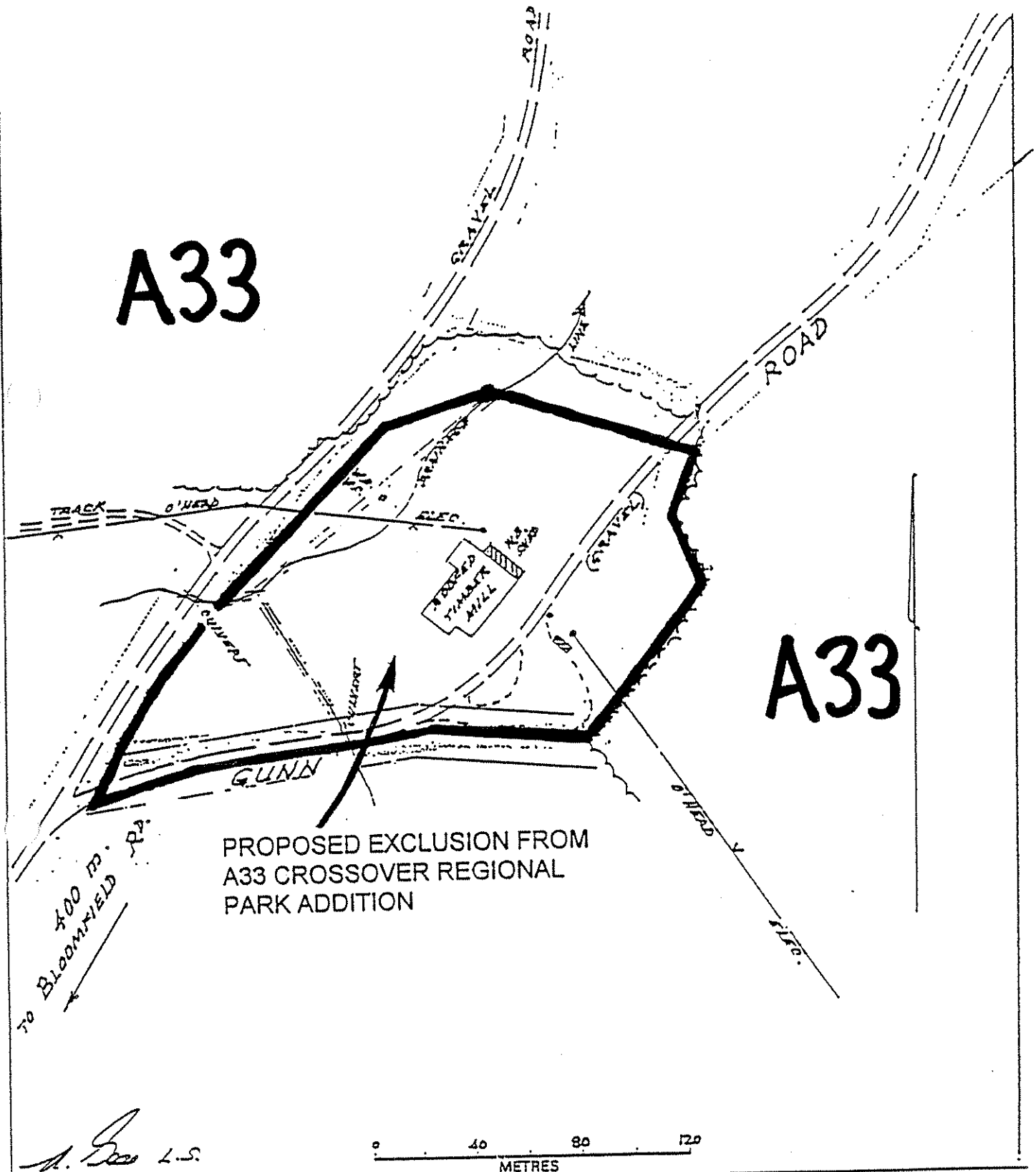

SURVEY AND MAPPING
VICTORIA

2 TREASURY PLACE
EAST MELBOURNE 3002 TEL (03) 651 2864

TOWNSHIP OF
CROSSOVER
PARISH OF NEERIM

ORIGINAL

SCALE
1:2000

SHE
SZ:
A:

PLAN No.

MAP P

PROPOSED NATURAL FEATURES RESERVE - BUSHLAND AREA, BEVERIDGE

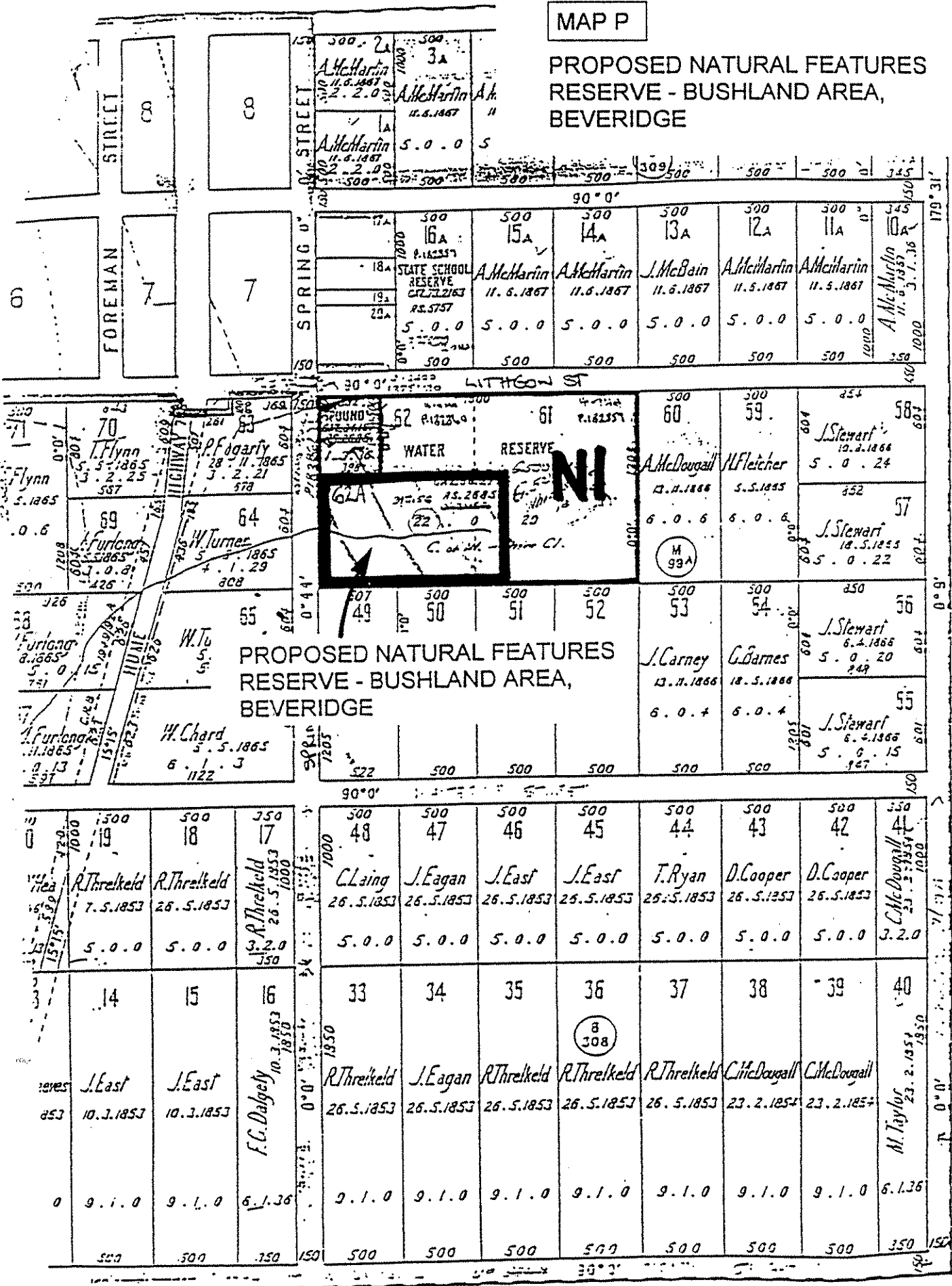

TOWNSHIP OF BEVERIDGE

PROPOSED NATURAL FEATURES RESERVE - BUSHLAND AREA, MURRINDINDI

PROPOSED NATURAL FEATURES
RESERVE - BUSHLAND AREA,
MURRINDINDI

10F

PARISH

OF

WOODBOURNE

PA

PARISH

**CERTIFICATE OF COMPLIANCE
(SUBSECTION 3.1)**

SUBORDINATE LEGISLATION THAT DOES NOT RESTRICT COMPETITION

I Marie Tahan, Minister for Conservation and Land Management,
and Minister responsible for administering the Land Conservation
Act 1970 certify that the proposed Order attached -

has been assessed in accordance with the Guidelines for the
Application of the Competition Test and the results
documented in the attachment to this certificate, and

the assessment shows that the proposed Order does not
restrict competition.

DATED: 12/6/97.

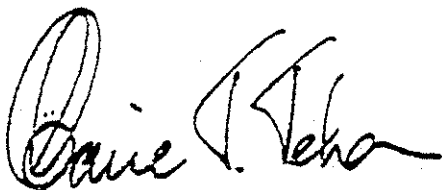

Marie Tahan
Minister for Conservation and Land Management